

Figure 12

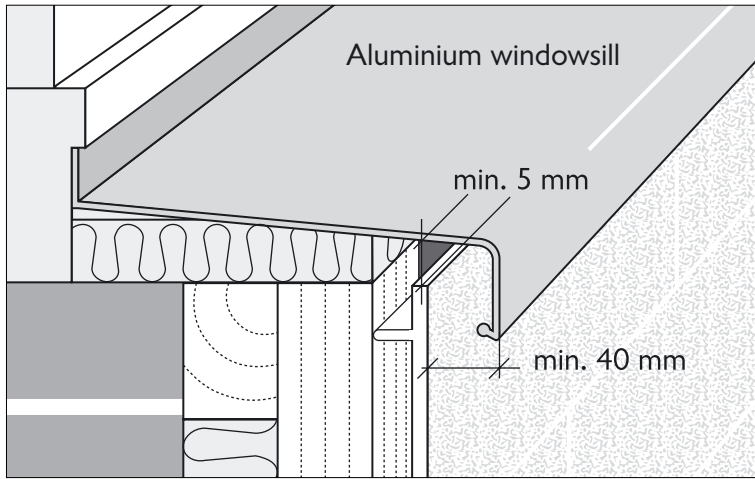

Figure 13

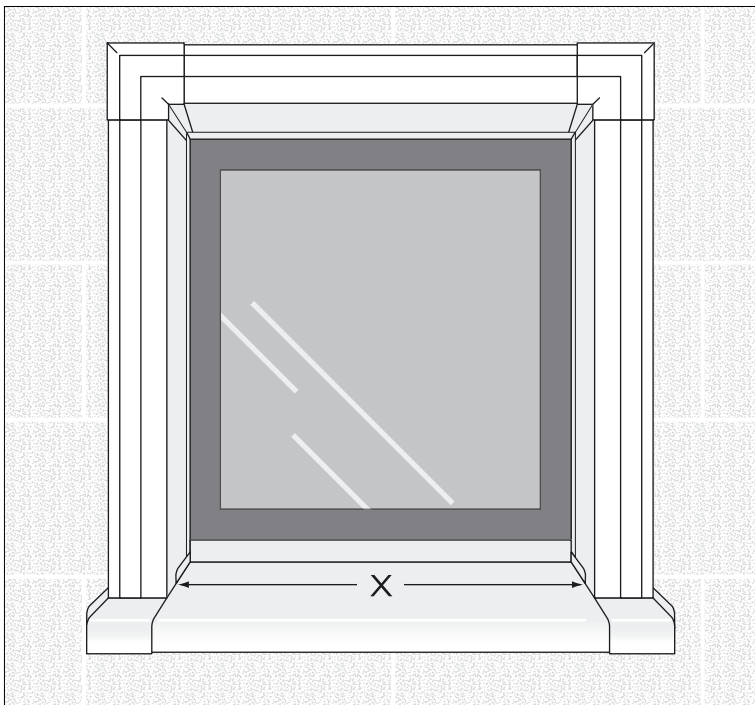
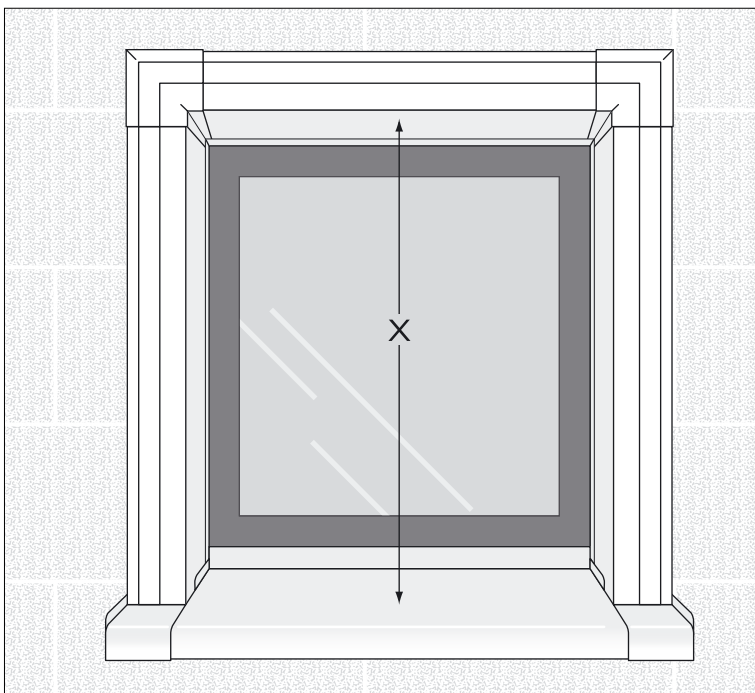

Figure 14



b) Windowsill

The windowsill has to be measured and attached so that the vertical reveal profiles are aligned above the end pieces (Figure 17). The end pieces have to be fitted into the cladding panels accordingly. (Also see: Figure 11)

c) Cutting the Upper Window Reveal

The window reveal is measured and cut according to the present reveal depth: The measuring of the depth starts from the façade surface at the window frame, and approximately 5 mm is subtracted from this depth.

The length of the upper window reveal profile is calculated as follows (Figure 13):

Width between the windowsill end pieces of the fitted windowsill (X)

- 10 mm

= required measurement of the upper window reveal profile

d) Cutting the Side Window Reveal

The length of the side window reveal profile is calculated as follows (Figure 14):

The height between the windowsill and bottom edge of the upper window reveal profile (X)

in the area of the façade front

- 6 mm

= required measurement of the side reveal profile

According to the slope of the windowsill, the soffit profile has to be cut diagonally in the bottom area (resources: protractor or similar).

